



**MONACO** SLIDING SYSTEMS  
FOR GLASS DOOR

**CGLASS**<sup>®</sup>  
GLASS FITTINGS

# 2022

**MONACO** SLIDING SYSTEMS

**CGLASS**<sup>®</sup>  
GLASS FITTINGS

**NORGPOL** Czerwiński Sp.J.

**Head Office**  
02-867 Warsaw  
Baletowa 104  
Poland

**Logistic Centre**  
08-500 Ryki  
Przemysłowa 4  
Poland

biuro@cglass.pl  
export@cglass.pl  
+48 22 33 15 400



[www.cglass.eu](http://www.cglass.eu)

**FOLLOW US ON**



# MONACO SLIDING SYSTEMS FOR GLASS DOOR

# MONACO SLIDING SYSTEMS FOR GLASS DOOR

## ACCESSORIES

### SINGLE SLIDING DOOR 80 KG



NTMON00-W1

### SINGLE SLIDING DOOR 150 KG



NTMON00W1-150

### DOUBLE SLIDING DOOR 80 KG



NTMON00-W2

### SYNCHRONOUS DOUBLE SLIDING DOOR 80 KG



NTMON-SYNCH-W2

- ✓ GLASS THICKNESS: **8-10 MM**
- ✓ MAX. DOOR WEIGHT: **80 KG / 150 KG**
- ✓ **SOFT CLOSE MECHANISM** BOTH SIDE
- ✓ MIN DOOR WIDTH: **700 MM / 1100 MM**
- ✓ **UNIVERSAL SLIDING PROFILE FOR TOP AND WALL FIXING** PATENTED

## TOP PROFILE FOR FIXED GLASS



NTMON1300-B

- ✓ LENGTH:
- 2200 MM
- 3000 MM
- 4000 MM
- 6000 MM

## SLIDING PROFILE



NTMON-B



G800-450-B  
L=450mm



NLO-ZD-2857-610-B  
L=635mm



NLO-ZD-2857-457-B  
L=480mm



NLO-ZD-2856-B  
L=230mm

## DOOR HANDLES



NTDL55-B



NTDL70-B



NTDL80-B



NTDL90-B

NO HOLES IN GLASS NEEDED

**PROFILE FOR MOUNTING  
TO GLASS WALL**



NTMON-5820

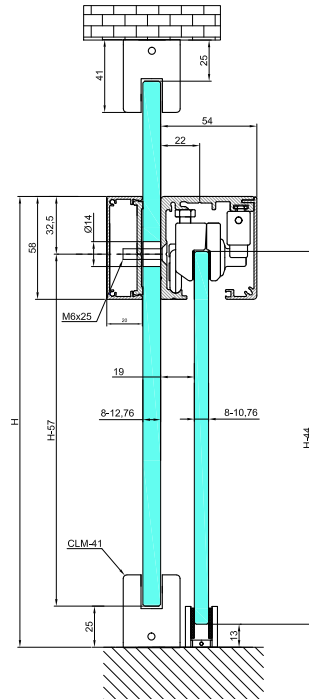

**DOOR LOCK FOR SLIDING DOOR**



NT301-B

NTW03-KK-B

**STRIKE BOX**

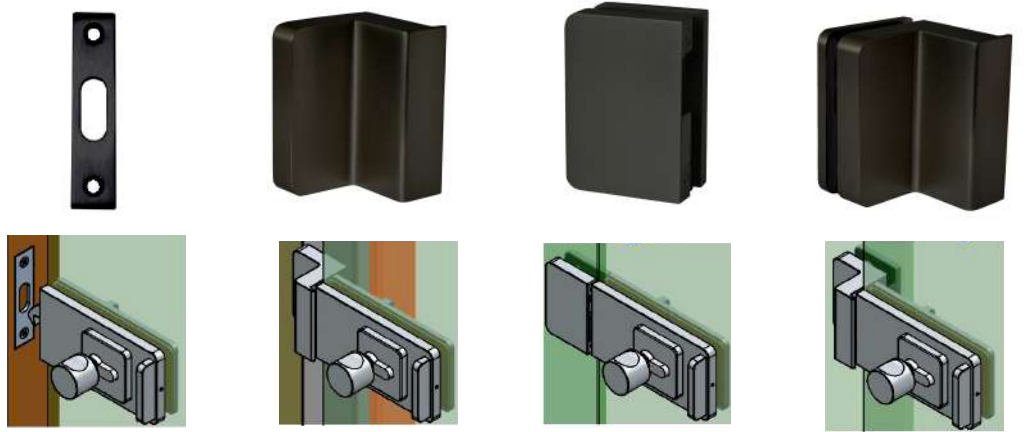

NTP301-B

NTP302-B

NTP303-B

NTP304-B

**ACCESSORIES FOR LOFT STYLE SLIDING DOOR**

**GRID PROFILE**

**ADHESIVE TAPE**

**U PROFILE**



CS-1902

CS-ACX-0,7-9-33

NLO-KP-2961